

An aerial photograph of a rural area in Cotuit, Massachusetts, with a green tint. The map shows a network of roads. Putnam Avenue runs diagonally from the upper left towards the center. Route 28 is visible on the right side of the map. The text 'Main Street' is written diagonally in the upper left. The main title is centered in large, bold, black font. The date and event information are centered below the title. The BETA logo is at the bottom center.

Putnam Avenue Conceptual Roadside Path Cotuit, Massachusetts

**Public Meeting
October 18, 2016**

Goals

- **Develop Concept Design for a Walkway/ Roadside Path**
- **Provide Context Sensitive Rural Appearance**
- **Prepare Visuals to Convey How it Will Look**



**Putnam Avenue Conceptual Roadside Path
Cotuit, Massachusetts**

Purpose

- Improve pedestrian safety
- Provide pedestrian connectivity to the Cotuit Community
- Promote walking and exercise in support of health

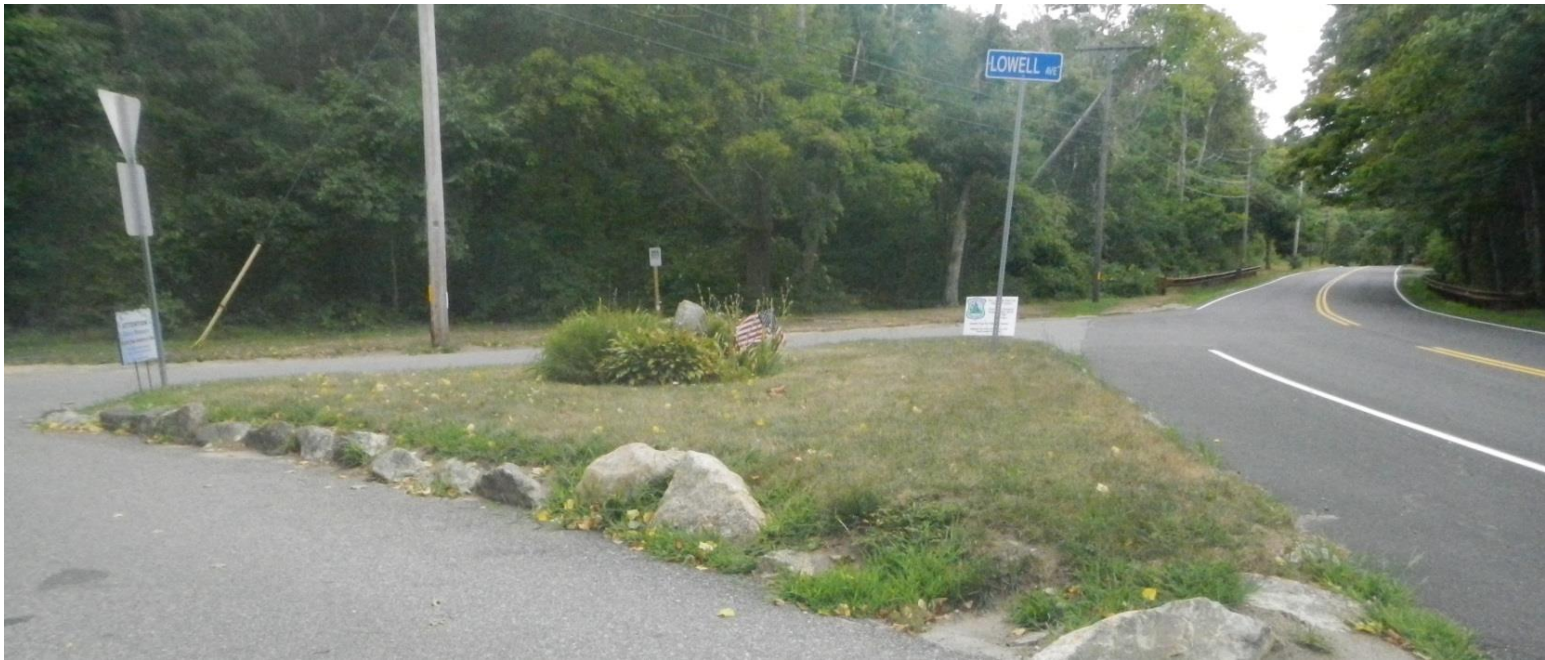

**Putnam Avenue Conceptual Roadside Path
Cotuit, Massachusetts**

Concept Design Process

- Listen to suggestions and preferences from the community
- Provide an understanding of site constraints and opportunities
- Develop concept alternatives for the walkway/ roadside path
- Present drawings to convey what the path can look like
- Follow Design Guidelines



Putnam Avenue Conceptual Roadside Path
Cotuit, Massachusetts

Design Guideline Resources

- **Rural Walking in Massachusetts, a Tool Kit for Municipalities 2013**
<http://www.walkboston.org/sites/default/files/WBRuralWalking.TKit%20final.draft.pdf>
- **Sustainable Neighborhood Road Design- A Guidebook for Massachusetts Cities and Towns**
<http://www.apa-ma.org/resources/publications/nrb-guidebook>
- **Barnstable Comprehensive Plans** including Village Plan 2005 and Heritage Preservation Inventory 2007, Barnstable Historic Preservation Plan 2010 Update
<https://www.townofbarnstable.us/ComprehensivePlanning>
- **The preservation Guide to Historic Roads** by Paul D. Marriott
www.historicroads.org/documents/GUIDE.pdf

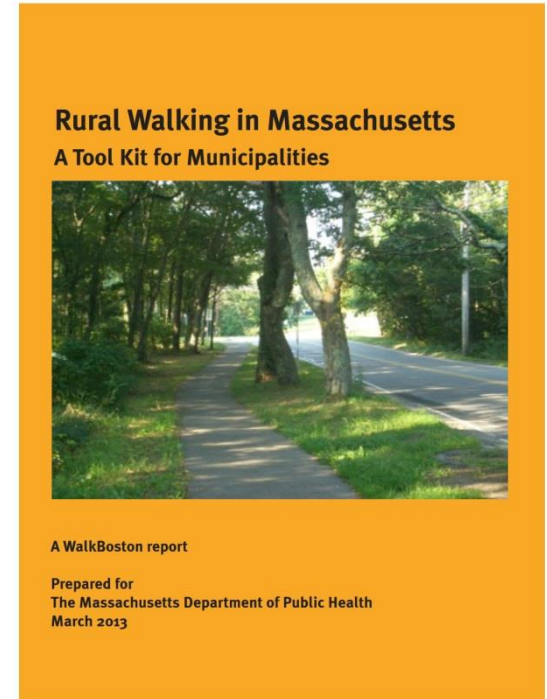

Design Guideline Resources



Americans with Disabilities Act (ADA) 2010 ADA Standards for Accessible Design

<https://www.ada.gov/regs2010/2010ADA>

- At Minimum, an unimpeded width of 3 feet
- A 3 foot path must have passing locations for wheelchairs
- (Min. 5 foot width) every 200 feet

Design Guidelines

Meandering Roadside Path:

- Context sensitive design
- Paved (asphalt)
- 4' – 5' wide
- Usually no curb
- Meanders at varying distances from the road
- Separated from the road by a minimum 2'+ grass strip
- Directs one to views and points of interest
- Meets ADA criteria

Site Constraints

- **Guardrail**
- **Crossings**
- **Steep Slopes**
- **Guardrail**
- **Right of Way (ROW) Limitations**
- **Potential Easement**
- **Utility Poles and other Obstructions**
- **Trees**
- **Curbing (need for)**



Site Constraints



Site Opportunities

- Provide pedestrian connections to existing trails and the ballfield
- Provide enjoyment of views
- Use Land Trust and Cemetery land
- Provide area for seating
- Provide rain gardens and stormwater solutions where practical



Path at top of Slope - A



**Putnam Avenue Conceptual Roadside Path
Cotuit, Massachusetts**

Path along Slope - B



Putnam Avenue Conceptual Roadside Path
Cotuit, Massachusetts

Path with Retaining Wall - C

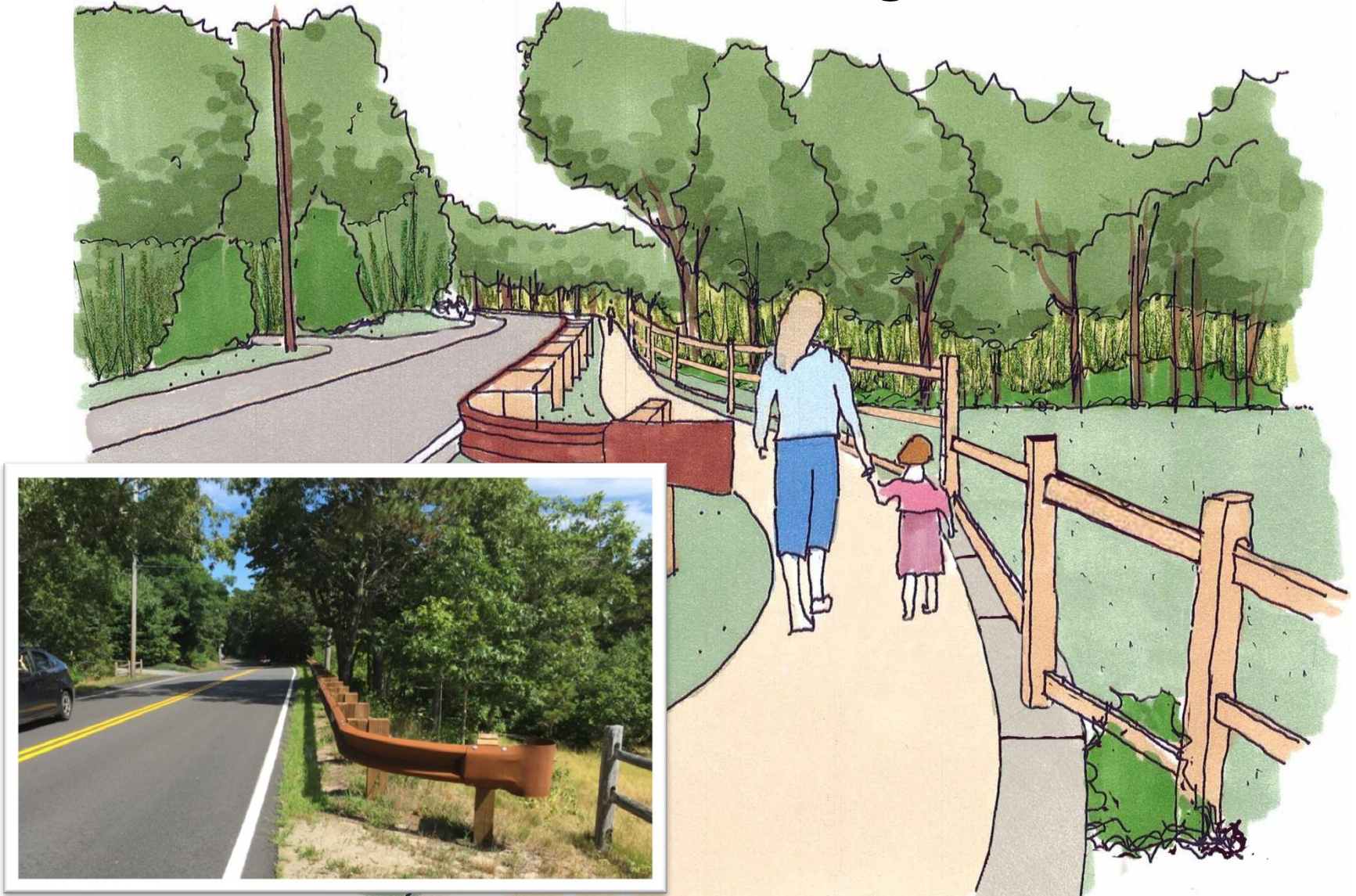

Putnam Avenue Conceptual Roadside Path
Cotuit, Massachusetts

Path at Field - D



Putnam Avenue Conceptual Roadside Path
Cotuit, Massachusetts

Path Crossing at Old Post Road - E



Putnam Avenue Conceptual Roadside Path
Cotuit, Massachusetts

Path with Guardrail - F

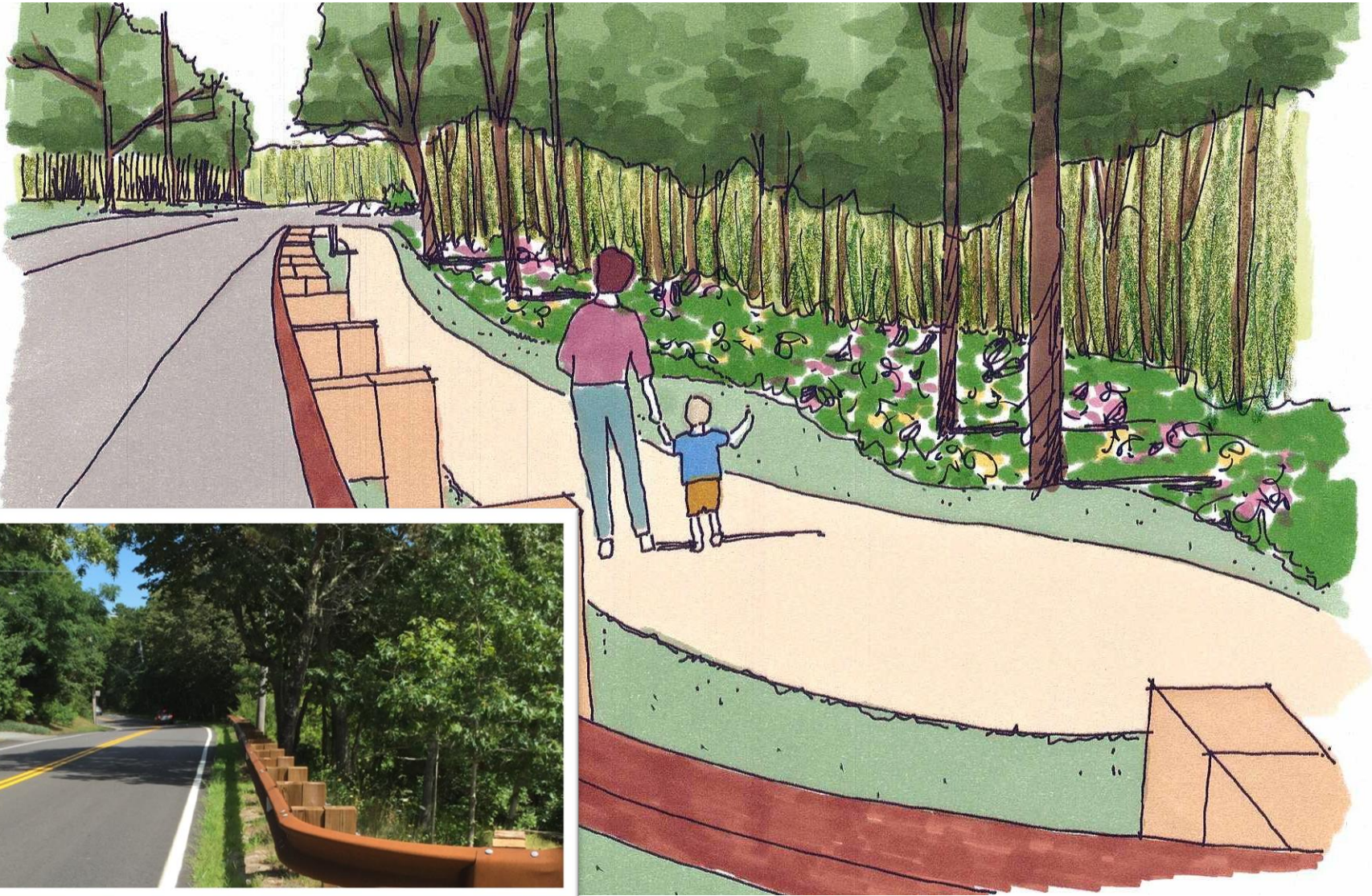

Putnam Avenue Conceptual Roadside Path
Cotuit, Massachusetts

Alignment Alternatives

PUTNAM AVENUE CONCEPTUAL ROADSIDE PATH COTUIT, MA Sheet 1

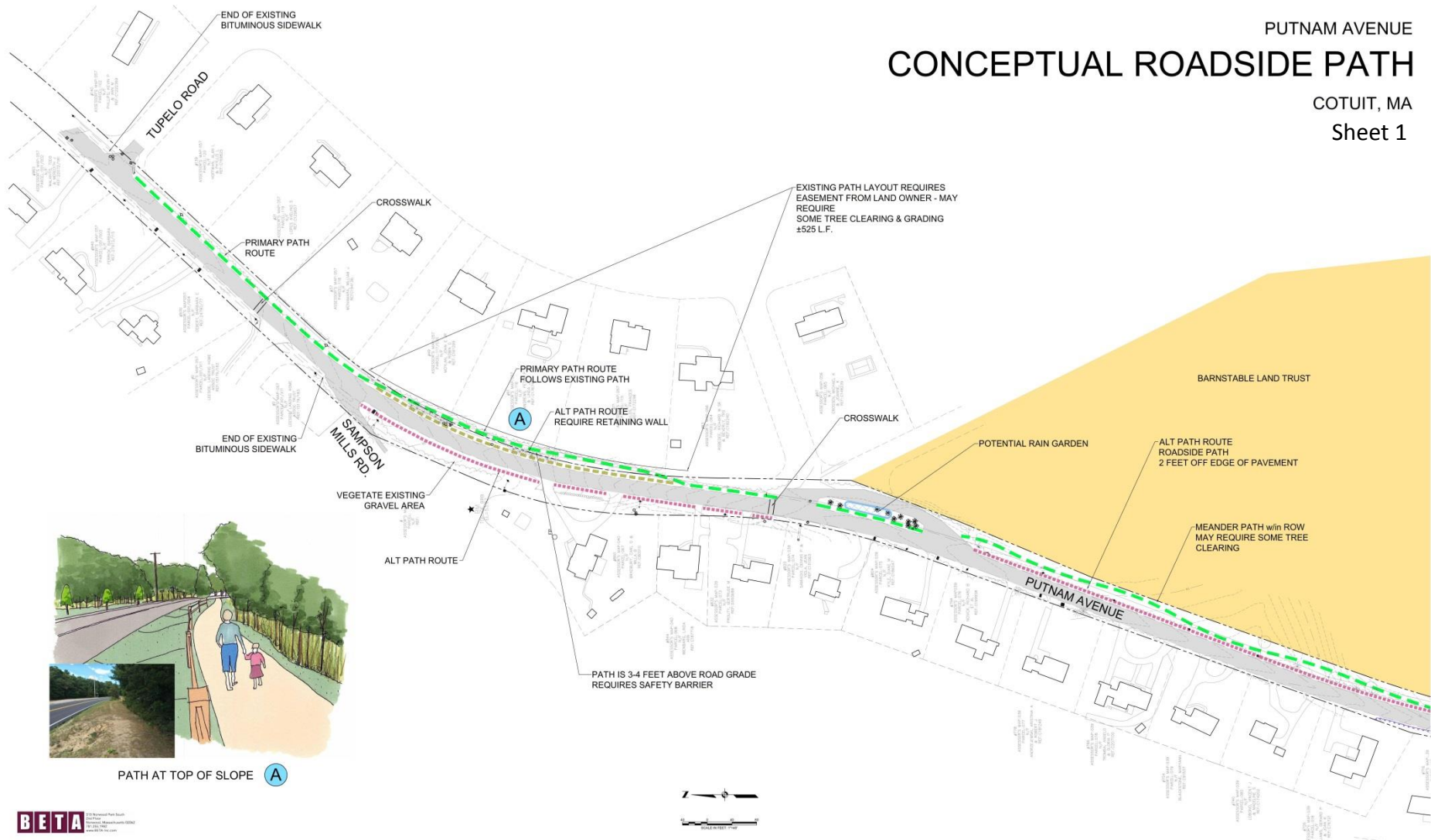

Alignment Alternatives

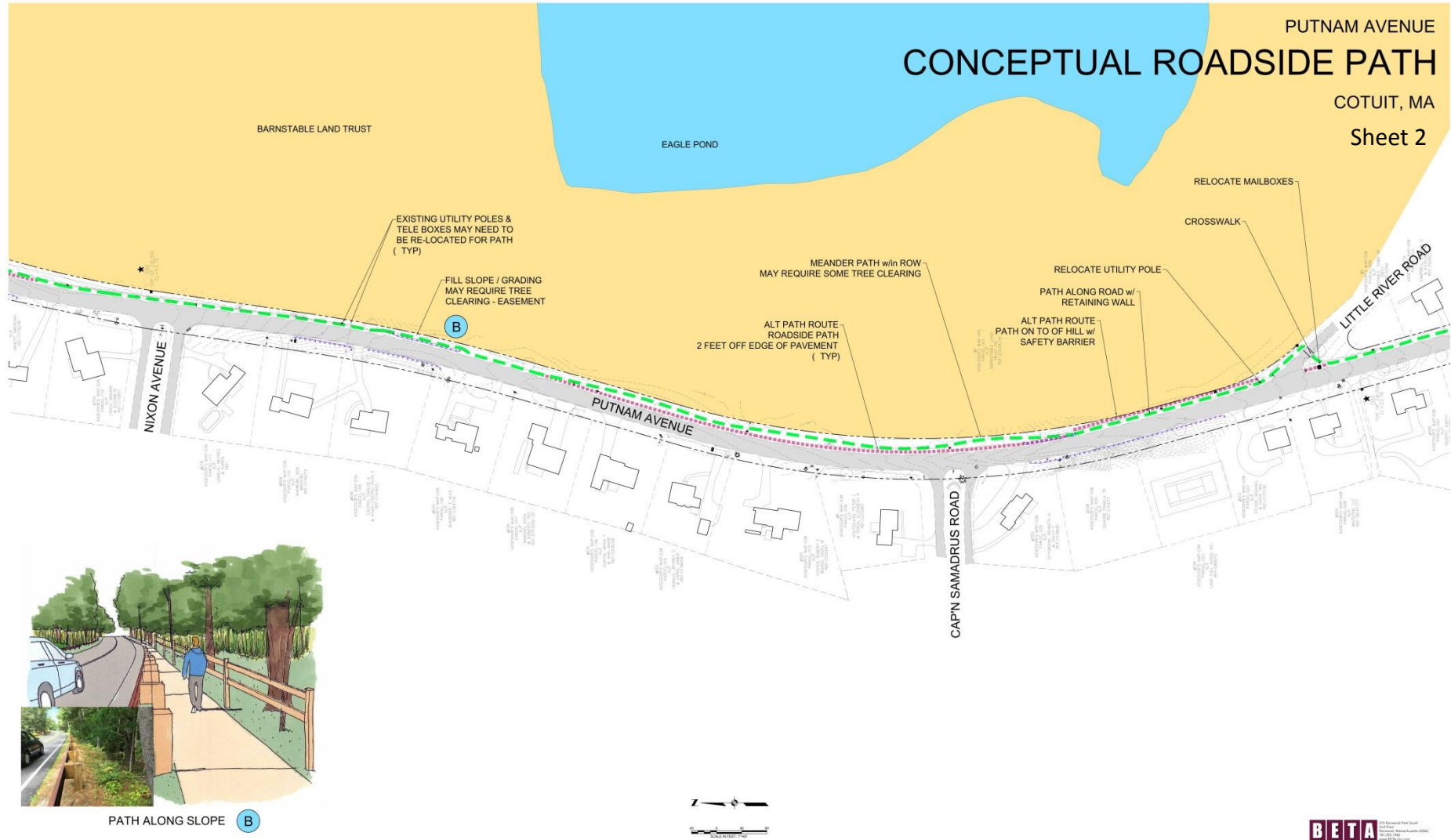

Alignment Alternatives

PUTNAM AVENUE CONCEPTUAL ROADSIDE PATH COTUIT, MA SHEET 3

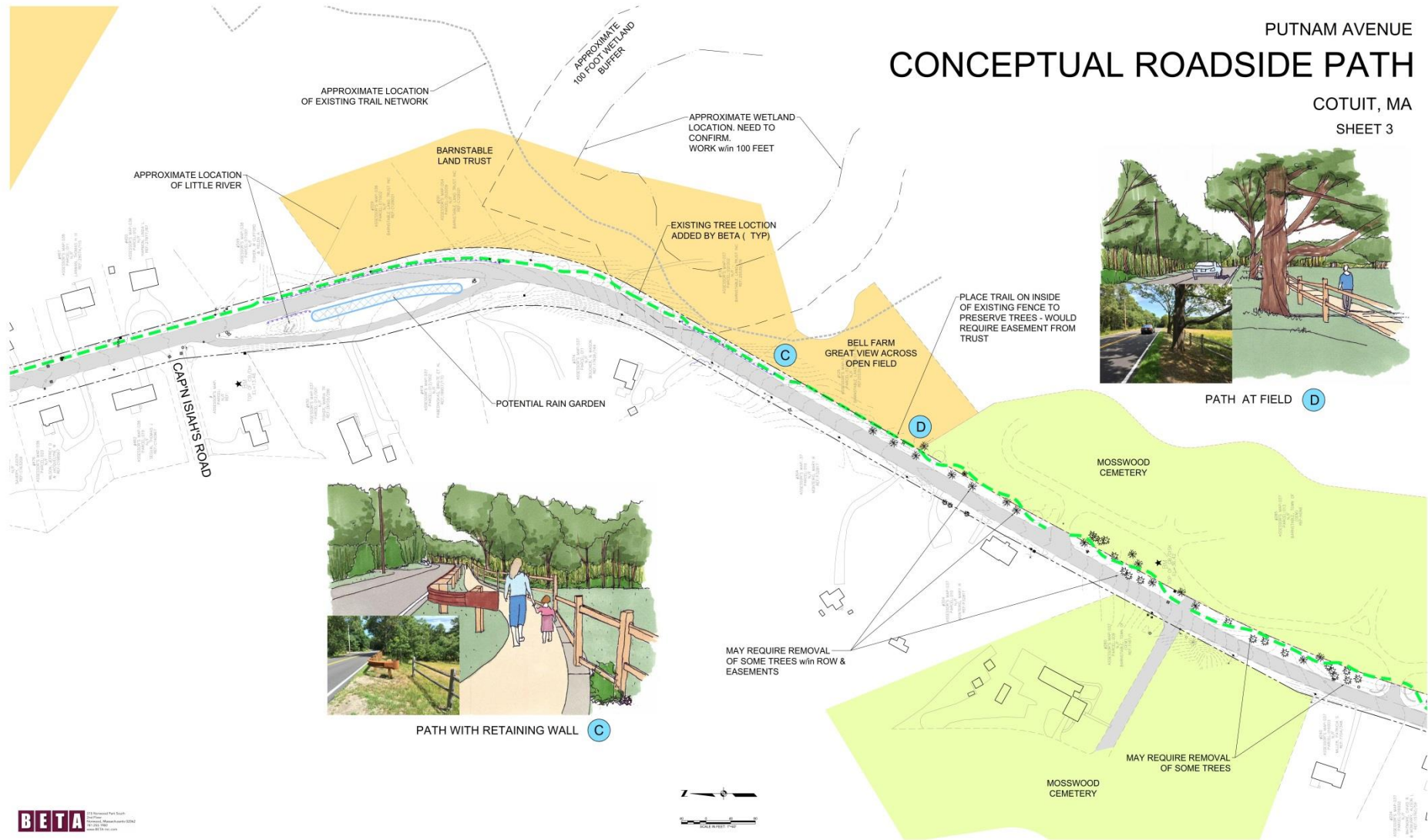

Alignment Alternatives

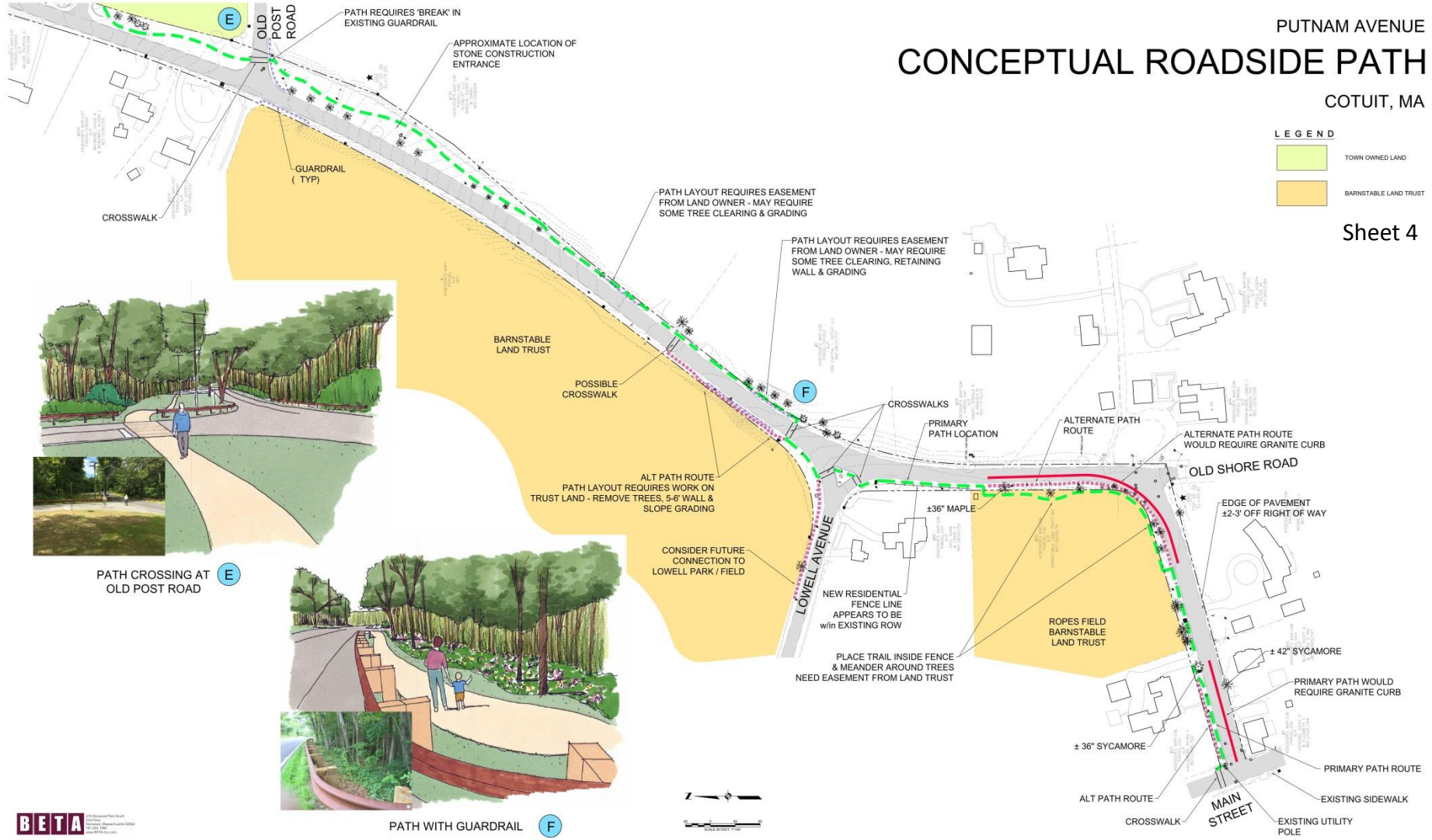

Typical Sections - 1

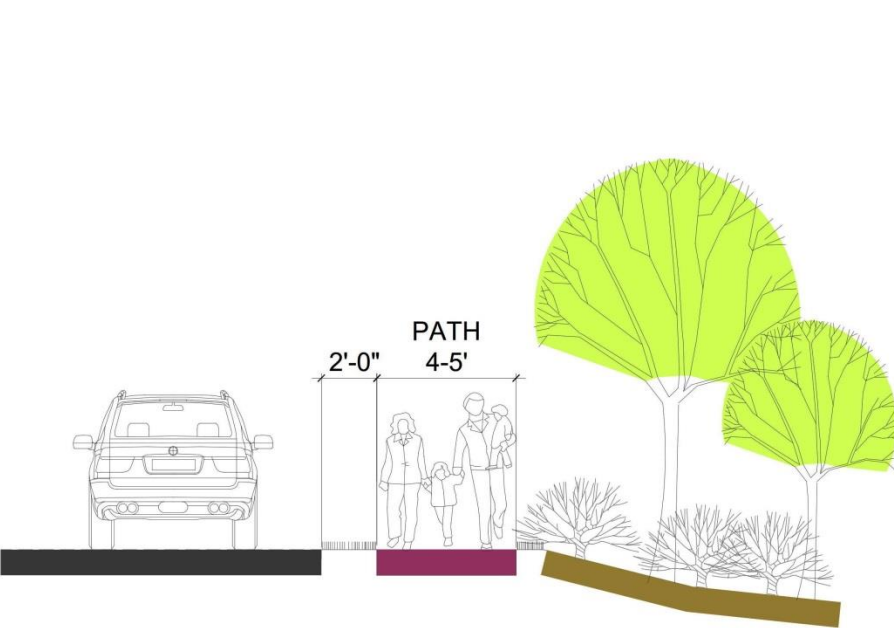

Typical Roadside Path

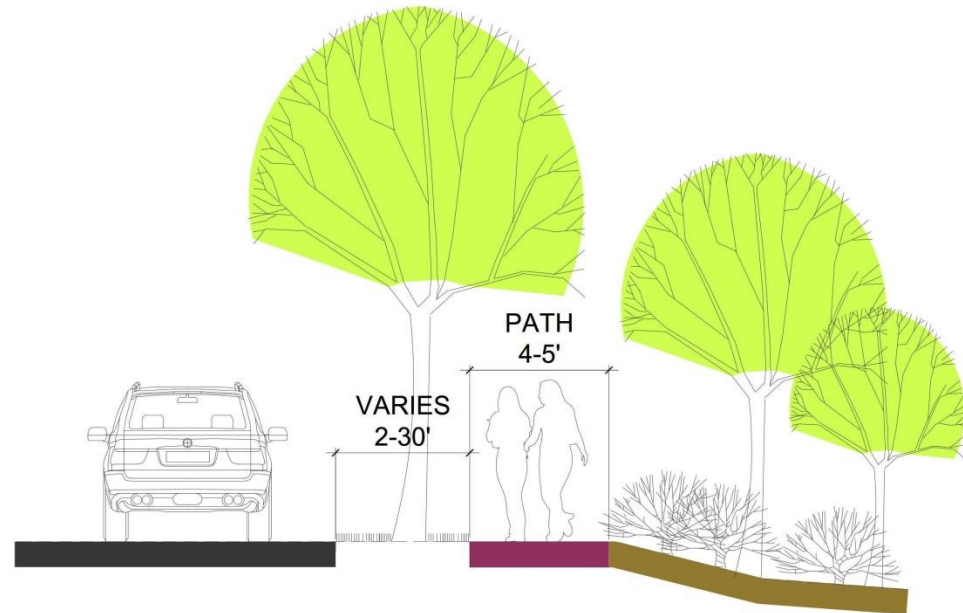

Typical
Meandering Roadside Path

Typical Sections - 2

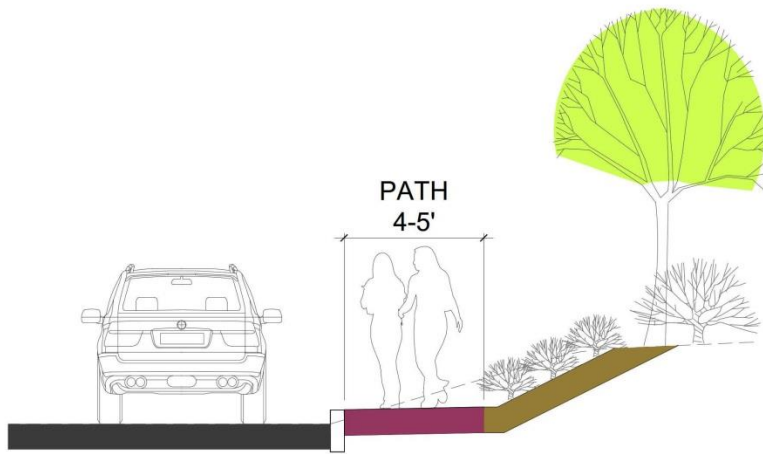

Path - Cut Section
Slope

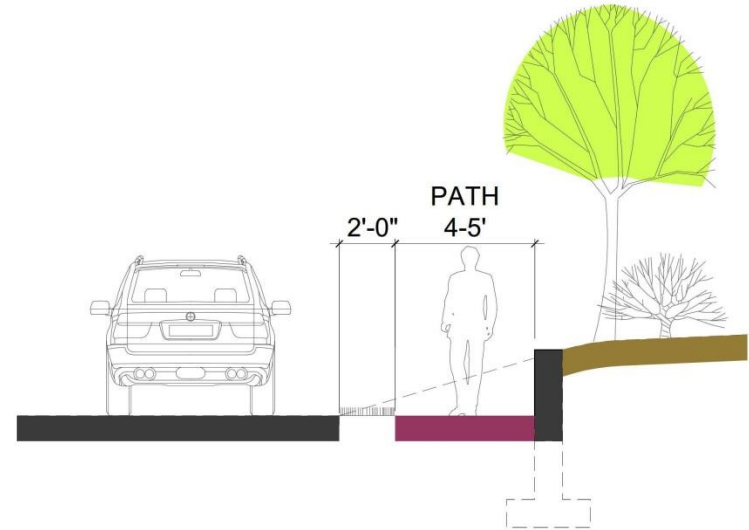

Path - Cut Section
Retaining Wall

Typical Sections - 3

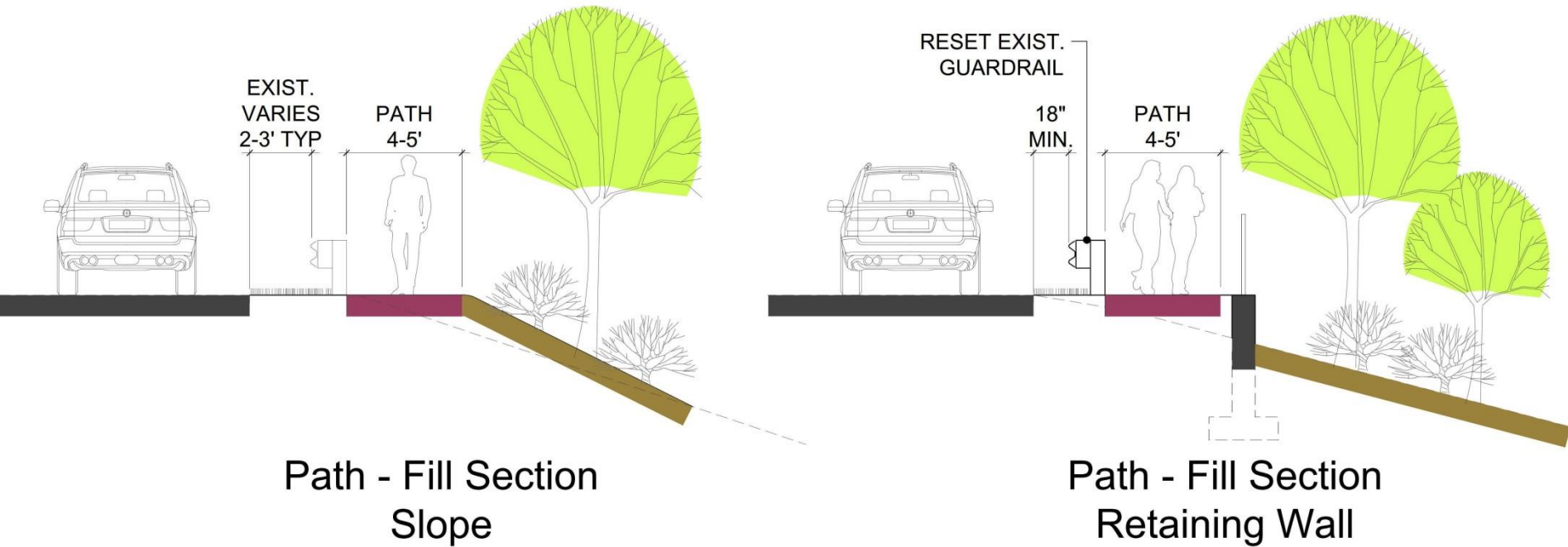

Detailed Cross Sections - 4

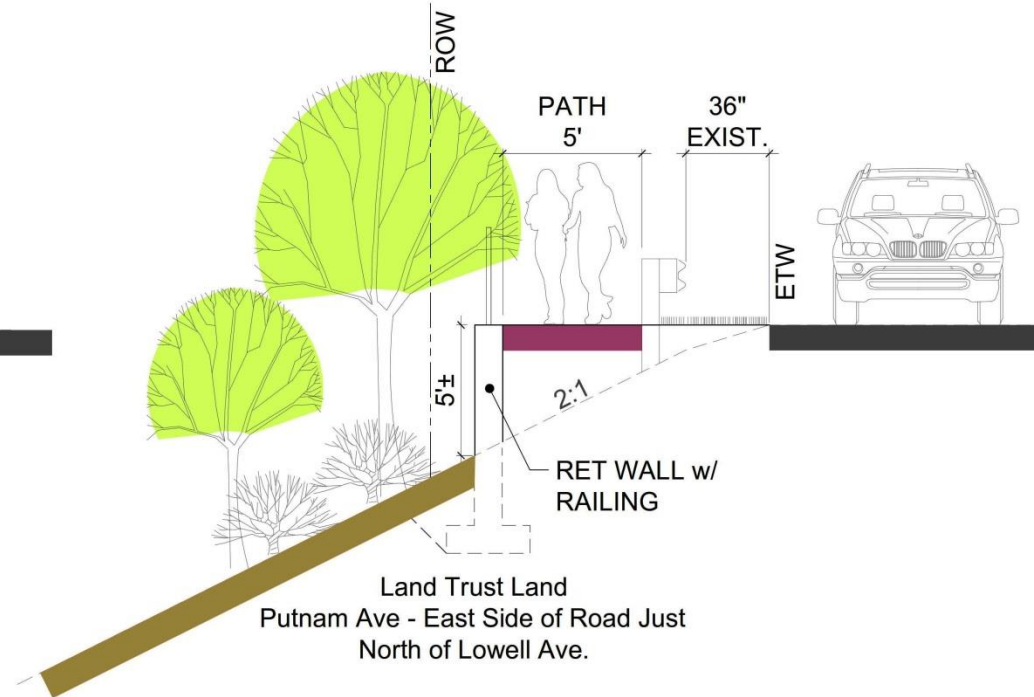
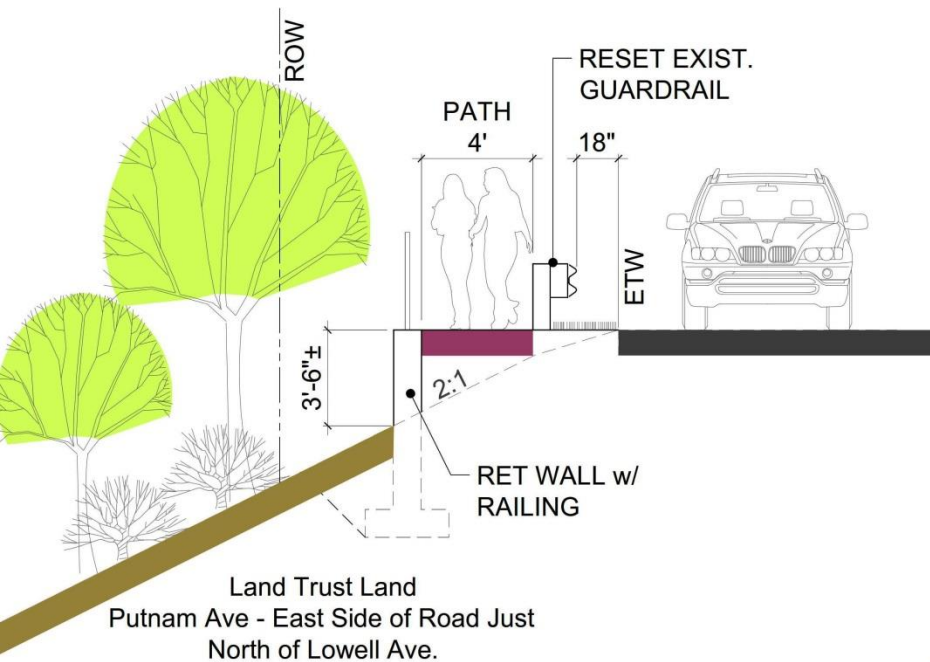

Detailed Cross Sections - 5

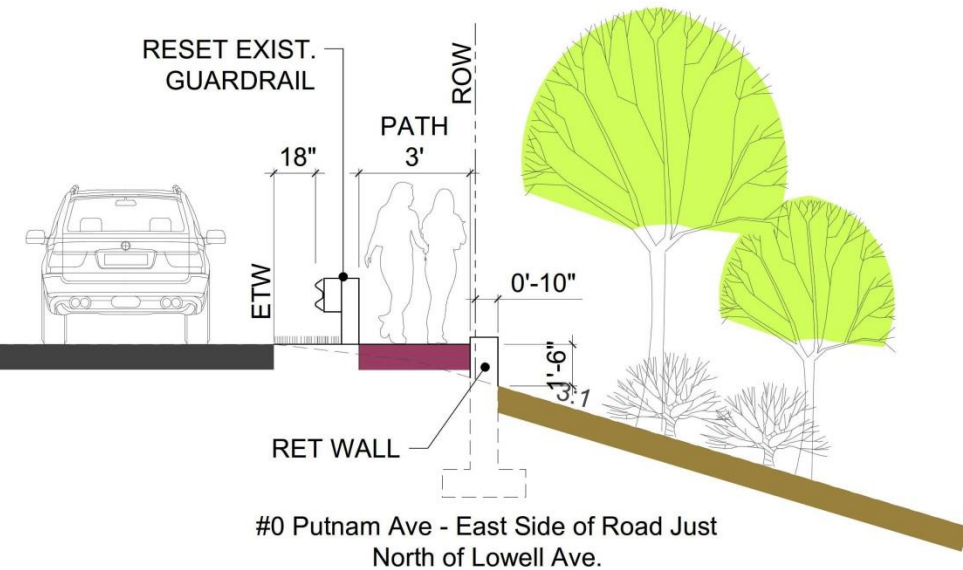
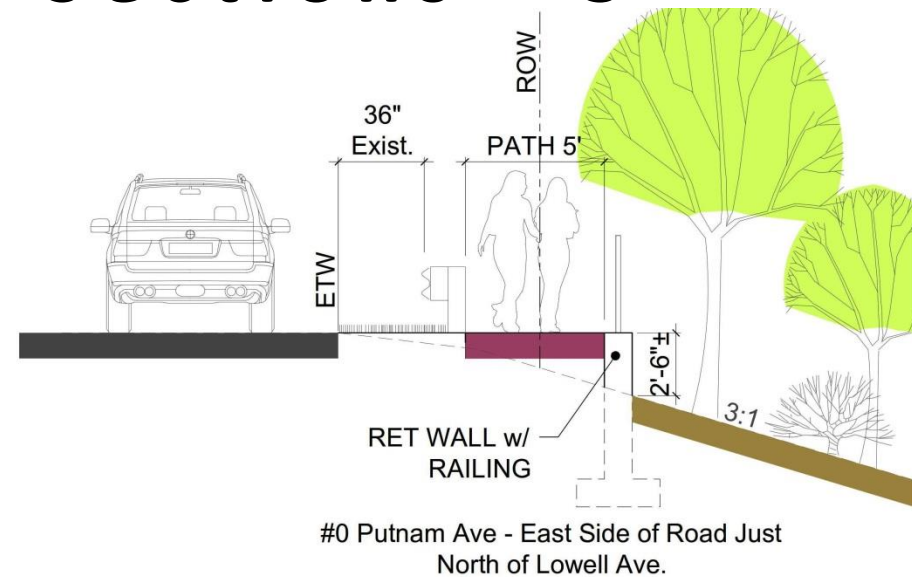
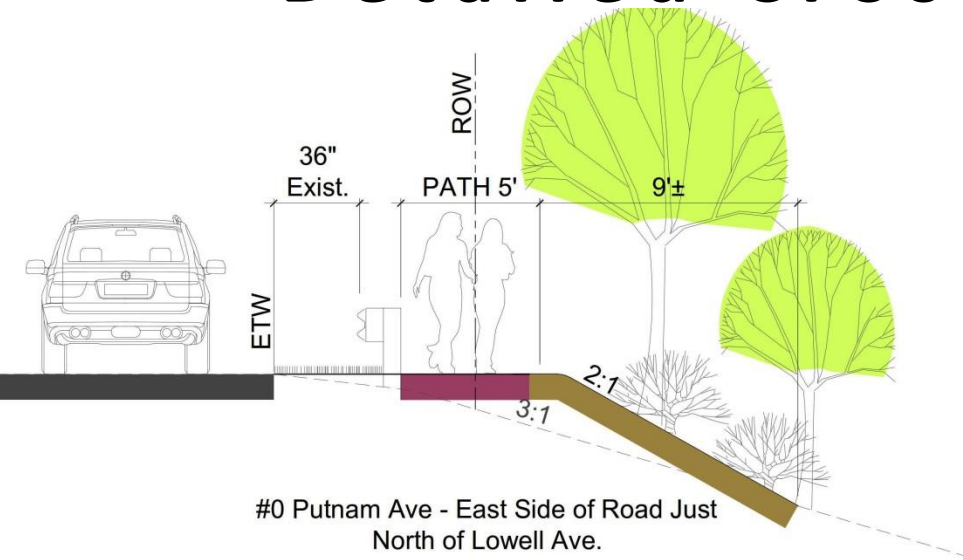

Detailed Cross Sections - 6

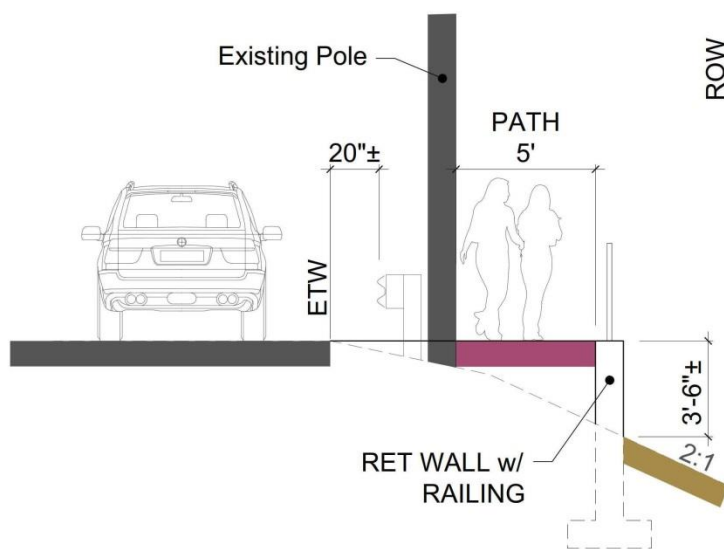

Across from UT Pole #23
near #374 Putnam Ave - East Side of
Road

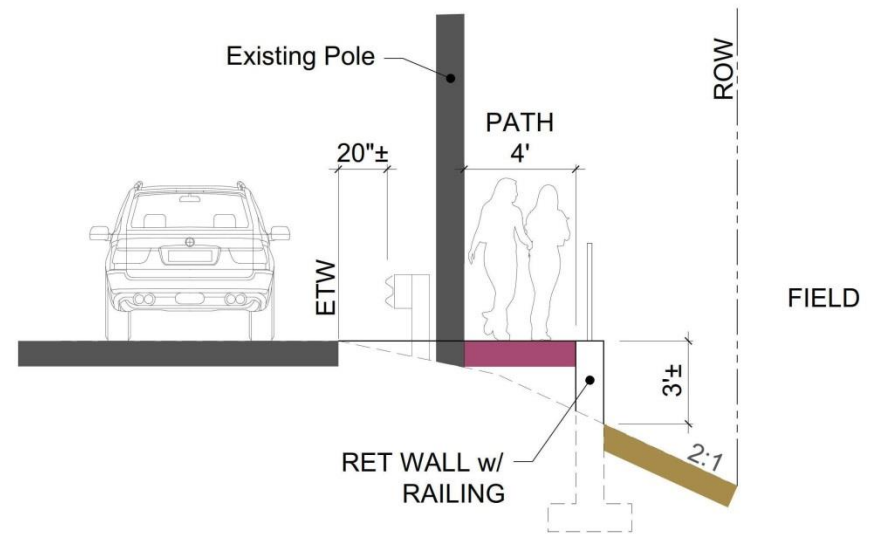

Across from UT Pole #23
near #374 Putnam Ave - East Side of
Road